

Unit:mm

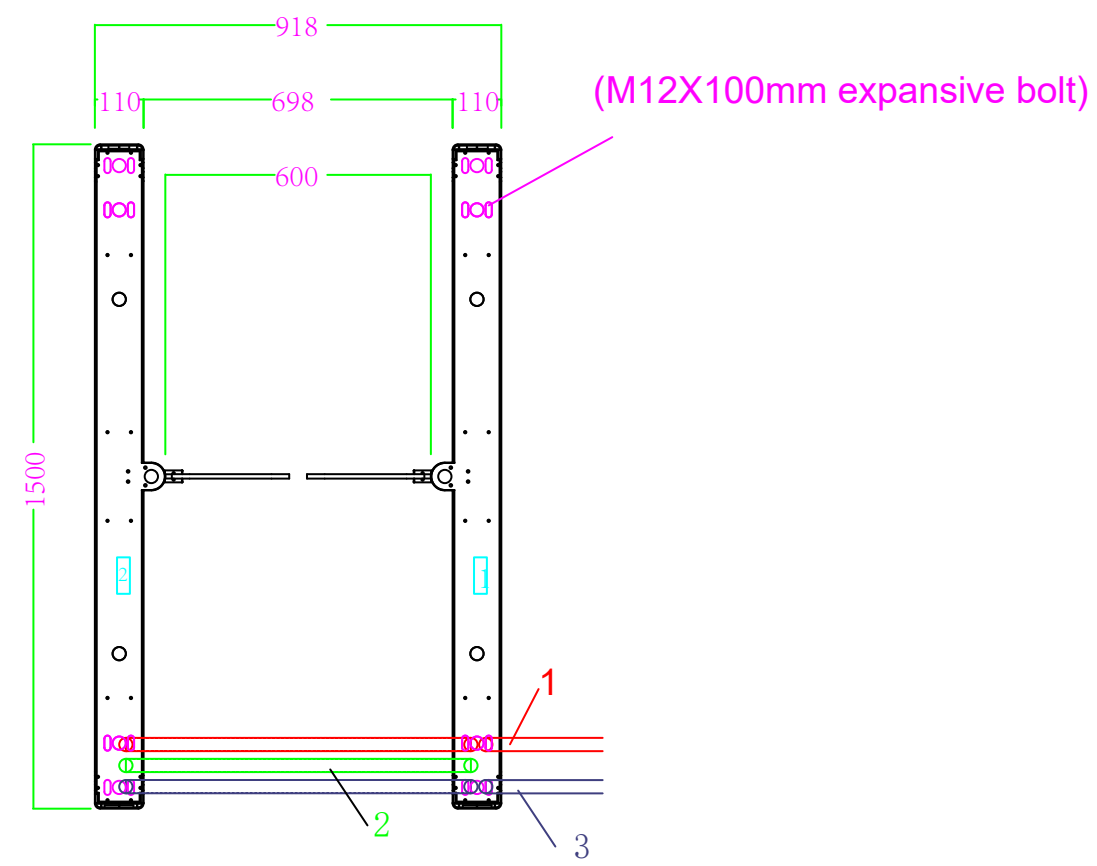
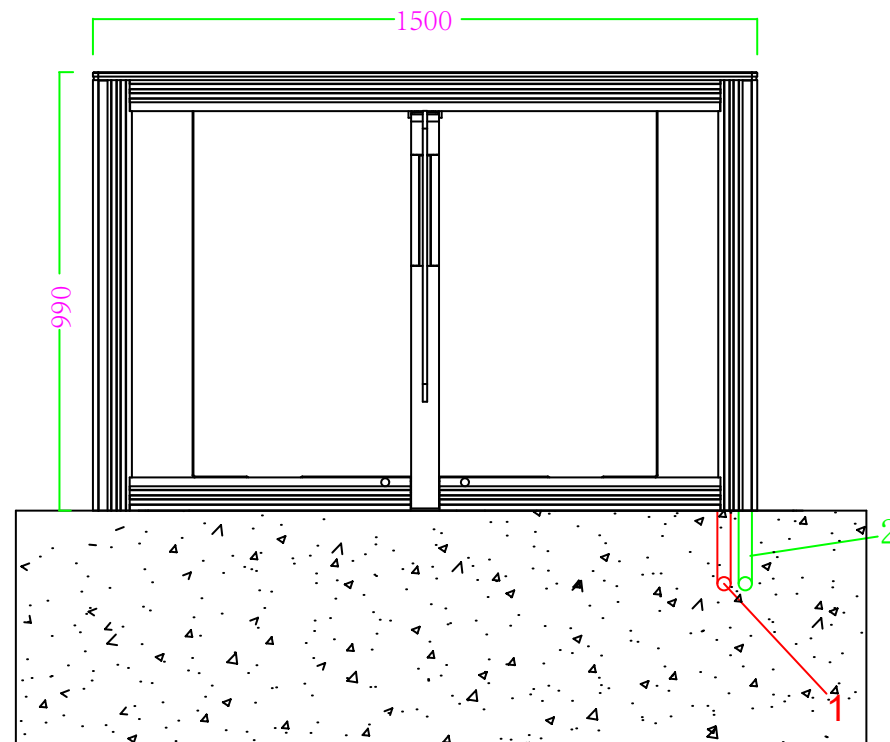
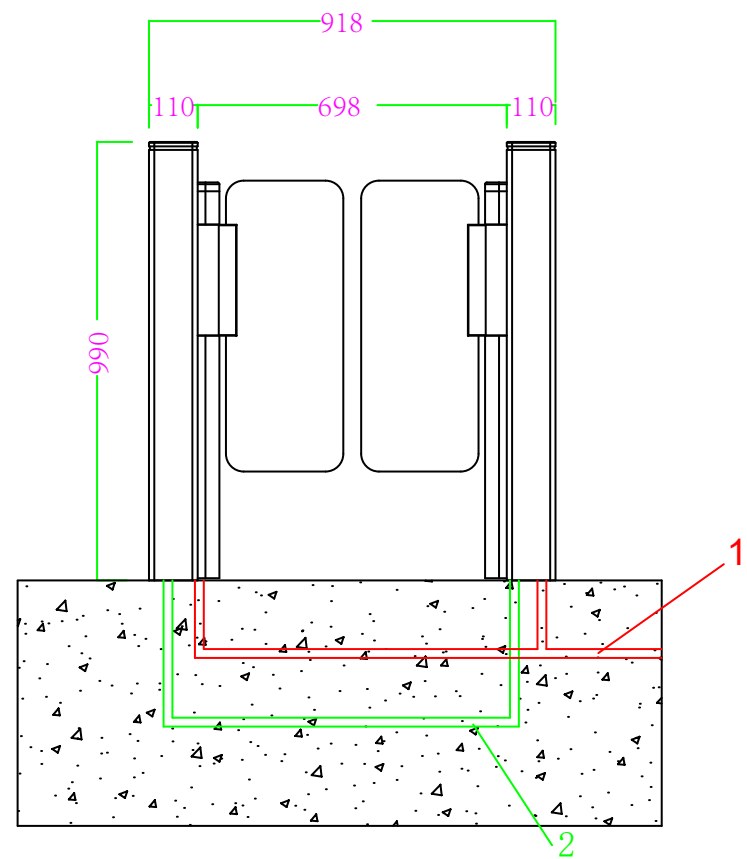

Installation Manual:

- 1 || The Ø20mm PVC tube for AC 220V Power wires(3 X Ø2.0mm).
- 2 || Online cable (2-core *1.0mm power cable *1, 8-core online cable *1, each channel between the host and the auxiliary equipment)
- 3 || TCP/IP ethernet cable for connecting access device to PC.
- 4 || 1.Master servo motor driver ,2 .Vice- servo motor driver.
- 5 ∞ Fixing the equipment with M12 X 90mm expansive bolt .

Mark:All wires extending out of the ground shall be no less than 2M.